

Supervisor: Dr. Eral Bele

Abdul Fattah Bin Mohd Radzif
Ahmad Aqil Bin Mohamed Ali
Aoxi Shan
Ays Yilmaz



Bamboo E-Bike

WHY?

More **environmental friendly** than normal bikes and cars.

SO?

Design and Build one **sustainable** bamboo e-bike with **aesthetic appearance**.



WHAT Joint Methods Attempt?

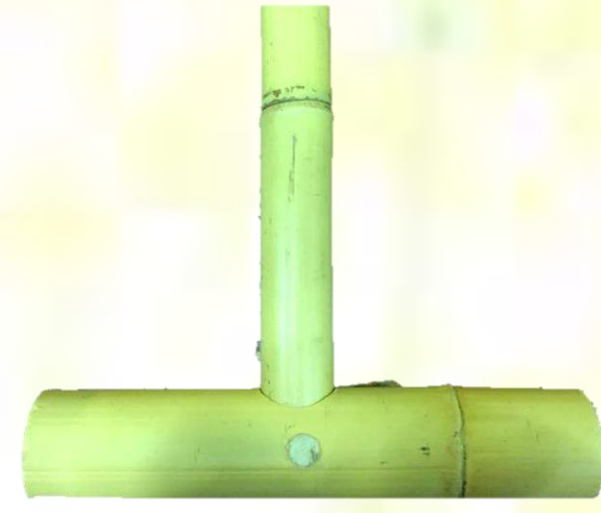

Dowel



Heat-shrunk Plastic Wrapping



Moulded



Heat-shrunk Sleeve

Final Method & WHY?

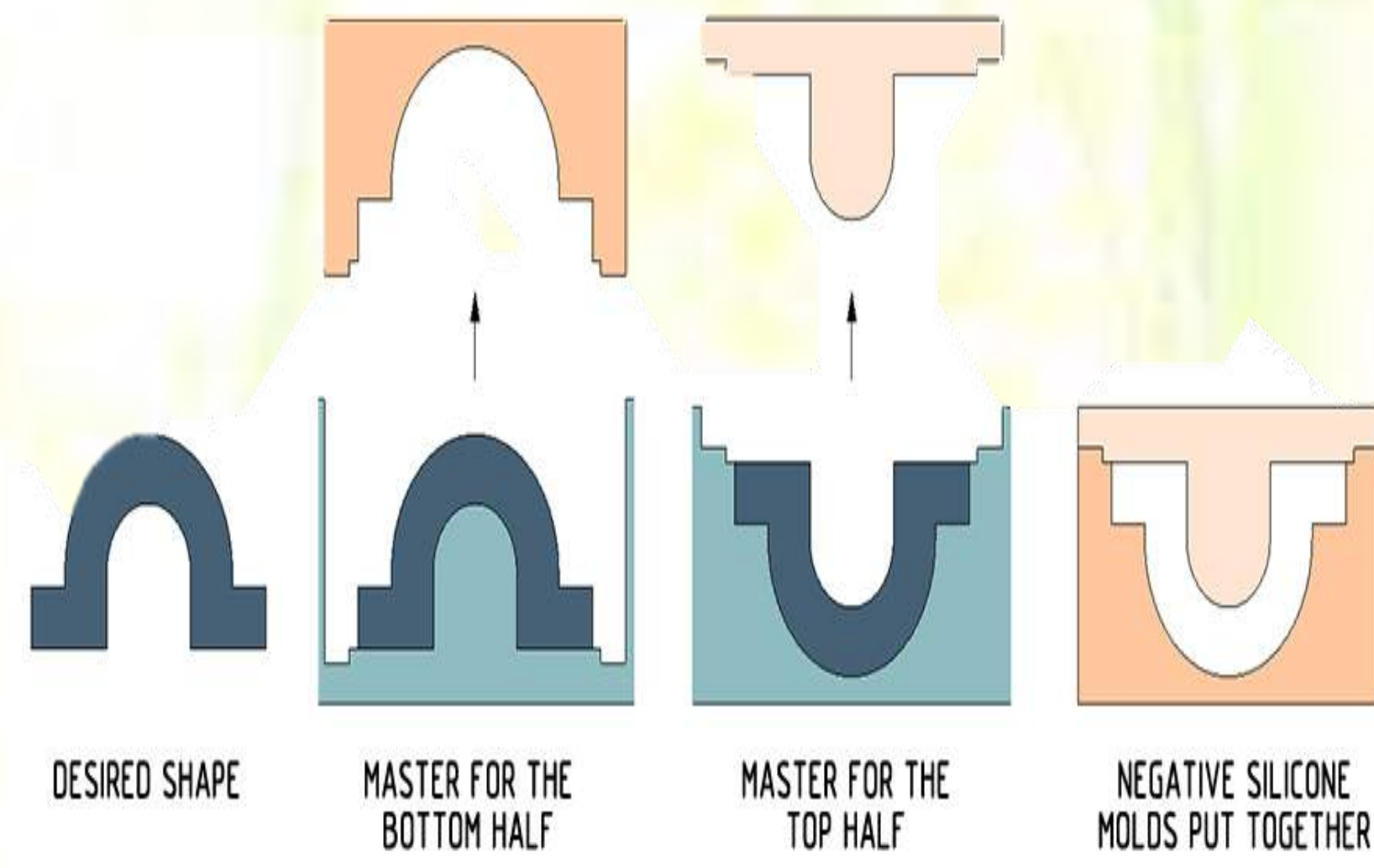

Moulded

1. Short completion time
2. Low manpower
3. Even surface
4. Portable
5. Recycle
6. Easy to manufacture
7. Easy removal process

69.24 kN (Compression Test)

56.91 kN (Tension Test)

76.97 kN (Shear Test)

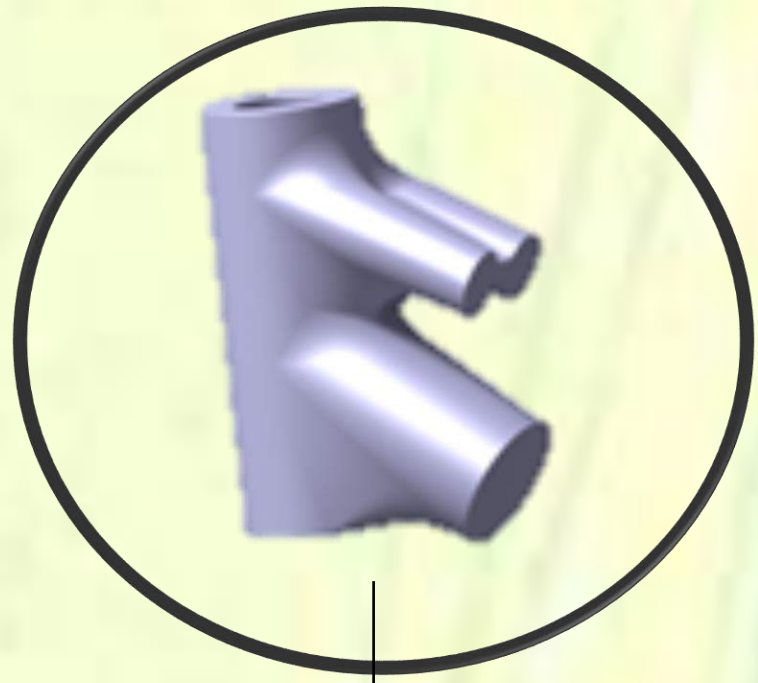

Styrofoam (positive mould)
By CATIA



Plywood (negative mould)
By CNC machine



Silicon Rubber (positive mould)

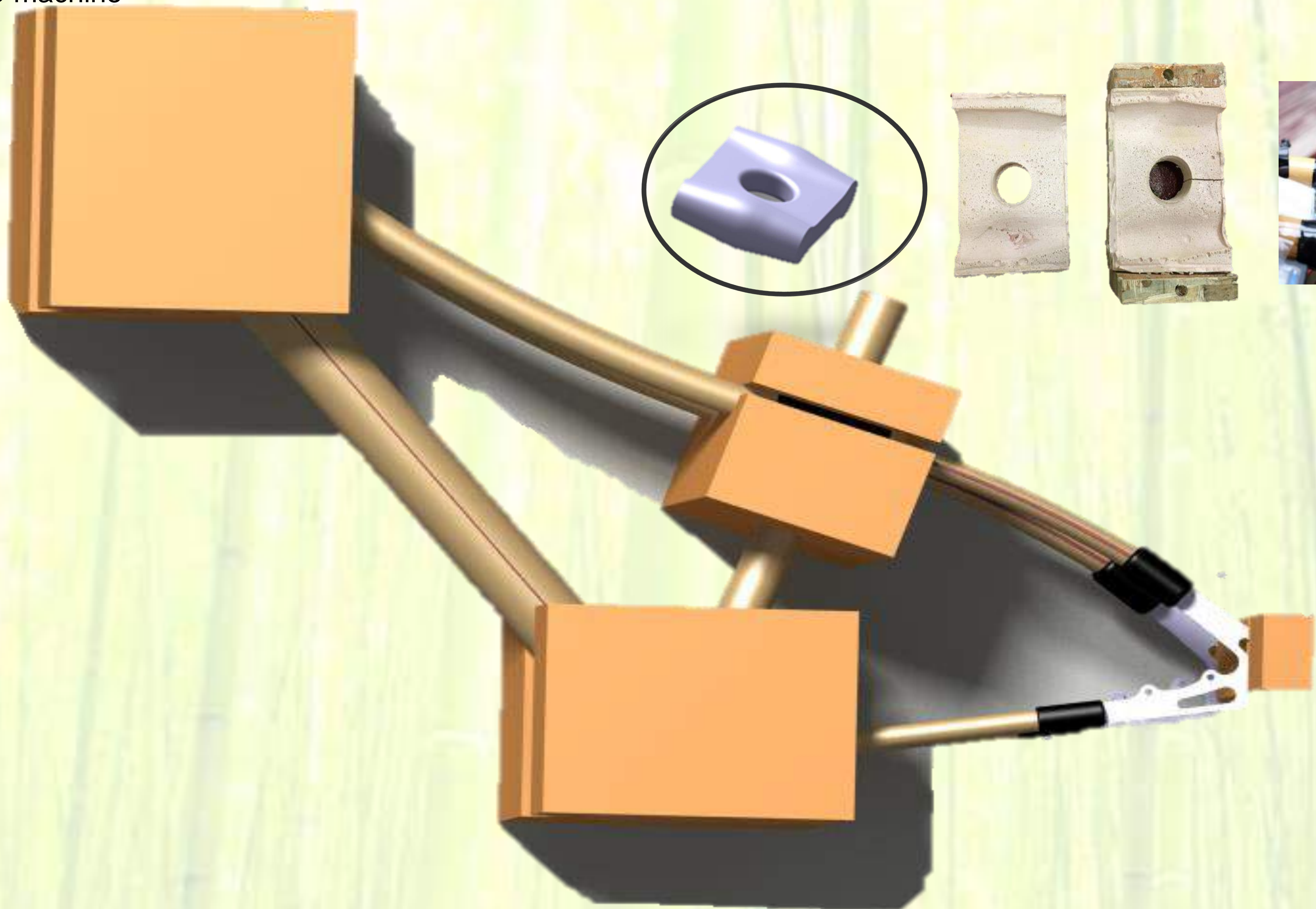

- @Pedal_progress
- @Pedalprogress
- pedalprogress@gmail.com
- pedalprogress.bike

